

## ISO 4017 / DIN 933 - HEXAGON BOLTS

- TO ISO 4017  
 - FULLY THREADED

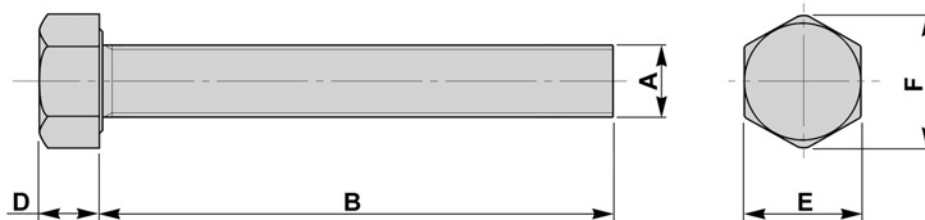

**ALL SIZES SHOWN ARE GRADE B ISO4017  
 GRADE A SIZES ALSO AVAILABLE ON REQUEST**

THREAD DIA	PITCH OF THREAD	E		F	D			RADIUS UNDER HEAD
		MIN	MAX	MIN	MIN	MAX	NOM	MIN
A	Coarse Pitch Series	GRADE B		GRADE B	GRADE B			
mm		mm	mm	mm	mm	mm	mm	mm
M12	1.75	17.57	18.00	19.85	7.21	7.79	7.50	0.60
M16	2	23.16	24.00	26.17	9.71	10.29	10.00	0.60
M20	2.5	29.16	30.00	32.95	12.15	12.85	12.50	0.80
(M22)	2.5	33.00	34.00	37.29	13.65	14.35	14.00	0.80
M24	3	35.00	36.00	39.55	14.65	15.35	15.00	0.80
(M27)	3	40.00	41.00	45.20	13.65	17.35	17.00	1.00
M30	3.5	45.00	46.00	50.85	18.28	19.12	18.70	1.00
(M33)	3.5	49.00	50.00	55.37	20.58	21.42	21.00	1.00
M36	4	53.8	55.00	60.79	22.08	22.92	22.50	1.00
(M39)	4	58.80	60.00	66.44	24.58	25.42	25.00	1.00
M42	4.5	63.10	65.00	71.30	25.58	26.42	26.00	1.20
(M45)	4.5	68.10	70.00	76.95	27.58	28.42	28.00	1.20
M48	5	73.10	75.00	82.60	29.58	30.42	30.00	1.60
(M52)	5	78.10	80.00	88.25	32.50	33.50	33.00	1.60
M56	5.5	82.80	85.00	93.56	34.50	35.50	35.00	2.00
(M60)	5.5	87.80	90.00	99.21	37.50	38.50	38.00	2.00
M64	6	92.80	95.00	104.86	39.50	40.50	40.00	2.00

**MATERIAL**

**GRADES**

4.6, 5.6, 6.9, 8.8, 10.9, 12.9

STAINLESS STEELS

**FINISH**

SELF COLOUR

GALVANISED

ELECTROPLATED

SHERARDISED

PTFE COATING

**NON STANDARD  
 THREAD LENGTH AVAILABLE  
 LENGTHS UP TO 3000MM**

**( ) = DENOTES NON PREFERRED SIZES**