

ISO 4014 / DIN 931 - HEXAGON BOLTS

- TO ISO 4014
- PART THREADED

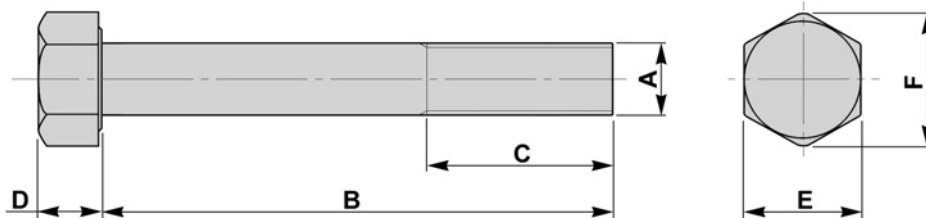

**ALL SIZES SHOWN ARE GRADE B ISO4014
GRADE A SIZES ALSO AVAILABLE ON REQUEST**

STANDARD THREAD LENGTHS	
Normal length of bolt B	Length of thread C
Up to and including 125mm	2A + 6mm
Over 125mm up to and including 200mm	2A + 12mm
Over 200mm	2A + 25mm

THREAD DIA	PITCH OF THREAD	DIA OF SHANK UNTHREADED		E		F	D			RADIUS UNDER HEAD
		GRADE B		GRADE B		GRADE B	GRADE B			
		MIN	MAX	MIN	MAX	MIN	MIN	MAX	NOM	MIN
mm	Coarse Pitch Series	mm	mm	mm	mm	mm	mm	mm	mm	mm
M12	1.75	11.57	12.00	17.57	18.00	19.85	7.21	7.79	7.50	0.60
M16	2	15.57	16.00	23.16	24.00	26.17	9.71	10.29	10.00	0.60
M20	2.5	19.48	20.00	29.16	30.00	32.95	12.15	12.85	12.50	0.80
(M22)	2.5	21.48	22.00	33.00	34.00	37.29	13.65	14.35	14.00	0.80
M24	3	23.48	24.00	35.00	36.00	39.55	14.65	15.35	15.00	0.80
(M27)	3	26.48	27.00	40.00	41.00	45.20	13.65	17.35	17.00	1.00
M30	3.5	29.48	30.00	45.00	46.00	50.85	18.28	19.12	18.70	1.00
(M33)	3.5	32.38	33.00	49.00	50.00	55.37	20.58	21.42	21.00	1.00
M36	4	35.38	36.00	53.8	55.00	60.79	22.08	22.92	22.50	1.00
(M39)	4	38.38	39.00	58.80	60.00	66.44	24.58	25.42	25.00	1.00
M42	4.5	41.38	42.00	63.10	65.00	71.30	25.58	26.42	26.00	1.20
(M45)	4.5	44.38	45.00	68.10	70.00	76.95	27.58	28.42	28.00	1.20
M48	5	47.38	48.00	73.10	75.00	82.60	29.58	30.42	30.00	1.60
(M52)	5	51.26	52.00	78.10	80.00	88.25	32.50	33.50	33.00	1.60
M56	5.5	55.26	56.00	82.80	85.00	93.56	34.50	35.50	35.00	2.00
(M60)	5.5	59.26	60.00	87.80	90.00	99.21	37.50	38.50	38.00	2.00
M64	6	63.26	64.00	92.80	95.00	104.86	39.50	40.50	40.00	2.00

MATERIAL

GRADES

4.6, 5.6, 6.9, 8.8, 10.9, 12.9

STAINLESS STEELS

FINISH

SELF COLOUR

GALVANISED

ELECTROPLATED

SHERARDISED

PTFE COATING

**NON STANDARD
THREAD LENGTH AVAILABLE
LENGTHS UP TO 3000MM**

() = DENOTES NON PREFERRED SIZES