

HAMMERHEAD T BOLTS

Brooks Forgings Ltd manufacture and supply Hammerhead T Bolts to DIN 7992, DIN 261, DIN 188 and DIN 186.

THE FULLY REMOVABLE FOUNDATION SYSTEM SOLUTION

When used in conjunction with pre-fabricated tube assemblies the Hammerhead T Bolt becomes a removable and reusable foundation solution.

With the tube assembly cast into concrete the bolt can be simply inserted and twisted through 90° locking it into the specially fabricated base plate.

In case of application error, commonly position or location issues, the low cost tube assembly can be discarded and the bolt removed for re-use during correct installation.



FORGING



MACHINING



ROLL THREADING



BOLT SIZES UP TO M100

**SPECIAL NON-STANDARDS
ON REQUEST**



DIN 7992 - HAMMERHEAD T BOLTS

BOLTS ARE MANUFACTURED TO REQUIRED LENGTHS IN ACCORDANCE TO DIN 7992

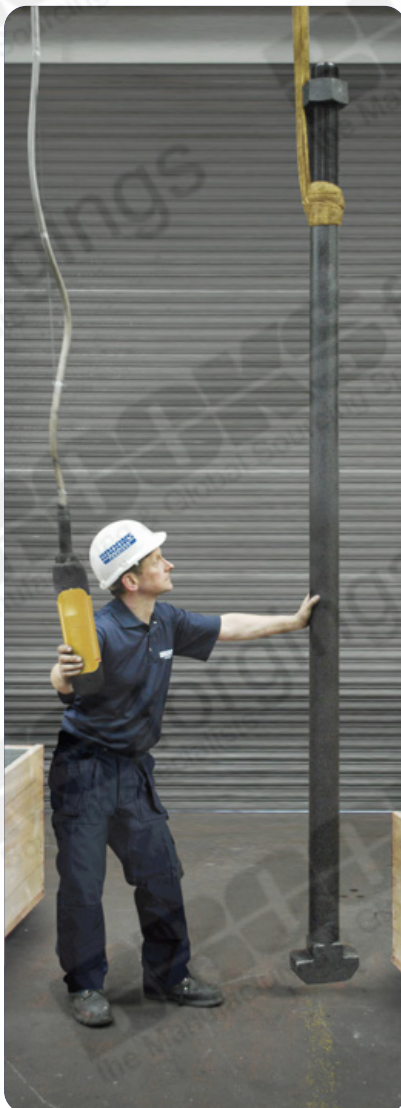
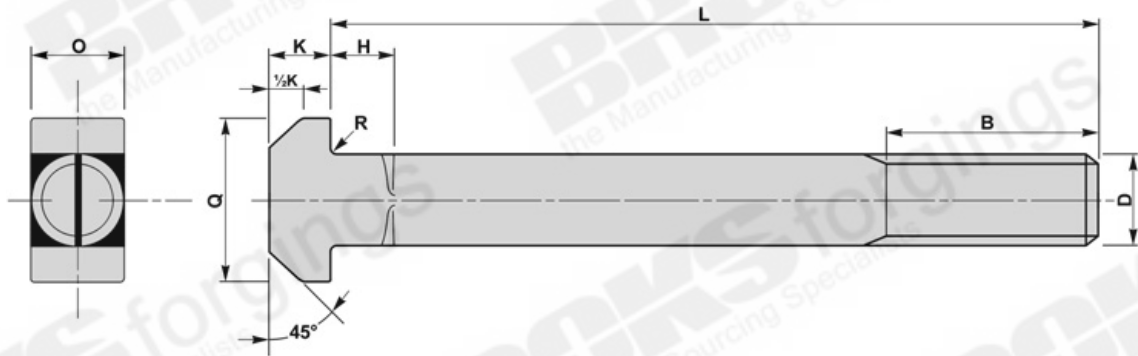

d	B	H	K	O	Q	R
mm ø	mm	mm	mm	mm	mm	mm
M24	100	18	18	24	65	1.6
M30	120	20	22	30	75	1.6
M36	140	25	25	36	85	2
M42	170	30	30	42	95	2
M48	200	30	35	48	110	2
M56	220	30	40	56	125	3
M64	240	30	50	64	140	3
M72 X 6	260	30	55	72	155	4
M80 X 6	290	30	60	80	170	4
M90 X 6	320	30	70	90	185	4
M100 X 6	350	30	75	100	205	5

SLOTTED PLATES - PAGE 40

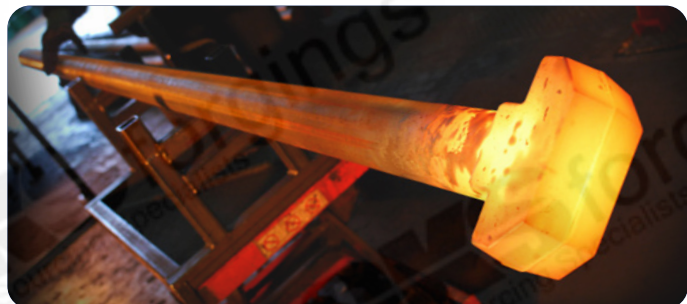

MATERIAL

- CARBON STEELS
- STAINLESS STEELS
- ALLOY STEELS
- B7, 4.6, 5.6, 8.8

FINISH

- SELF COLOUR
- GALVANISED
- ELECTROPLATED
- SHERARDISED
- PTFE COATING

DIN 261 - HAMMERHEAD T BOLTS

BOLTS ARE MANUFACTURED TO REQUIRED LENGTHS IN ACCORDANCE TO DIN 261

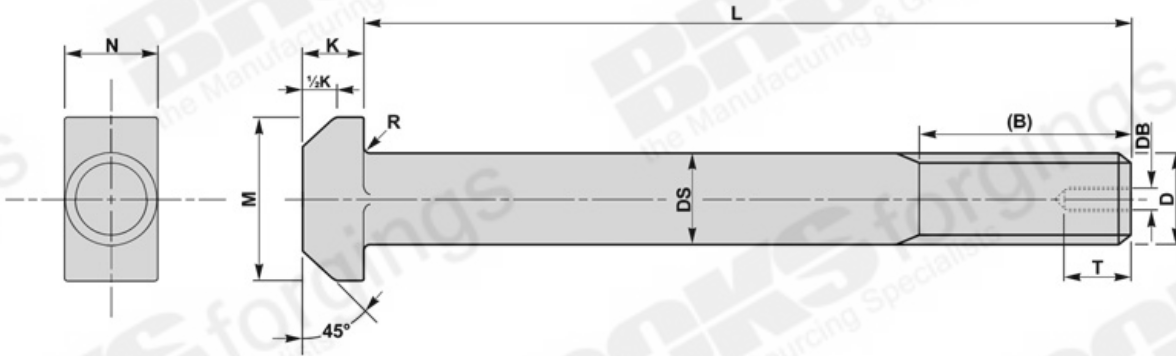

d	PI	B2 ≤ 120	B3 ≤ 200	B4 > 200	db	ds	K	N	M	R min	T
mm	mm	mm	mm	mm	mm	mm	mm	mm	mm	mm	min
M24	3	54	60	73	-	24	15	24	43	0.8	-
M30	3.5	66	72	85	-	30	19	30	54	1.0	-
M36	4	78	84	97	M12	36	23	36	66	1.0	22
M42	4.5	90	96	109	M12	42	26	42	80	1.2	22
M48	5	-	108	121	M12	48	30	48	88	1.6	22
M56	5.5	-	124	137	M16	56	35	56	102	2.0	26
M64	6	-	130	143	M16	64	40	64	115	2.0	26
M72	6	-	-	169	M16	72	45	72	128	2.0	26
M80	6	-	-	185	M20	80	50	80	140	2.0	33
M90	6	-	-	205	M20	90	55	90	155	2.5	33
M100	6	-	-	225	M20	100	62	100	170	2.5	33

DIN 261 WITH REDUCED SHANK ALSO AVAILABLE ON REQUEST

PI - Pitch of thread (coarse)

B2 - For overall length underhead up to and including 120mm

B3 - For overall length underhead up to and including 200mm

B4 - For overall length underhead exceeding 200mm

**SLOTTED PLATES
PAGE 40**

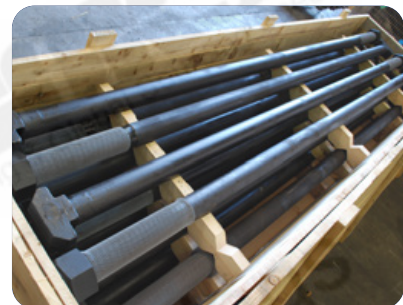



ISO 9001



Approved



national highway sector schemes

Approved

DIN 188 - HAMMERHEAD T BOLTS

BOLTS ARE MANUFACTURED TO REQUIRED LENGTHS IN ACCORDANCE TO DIN 188

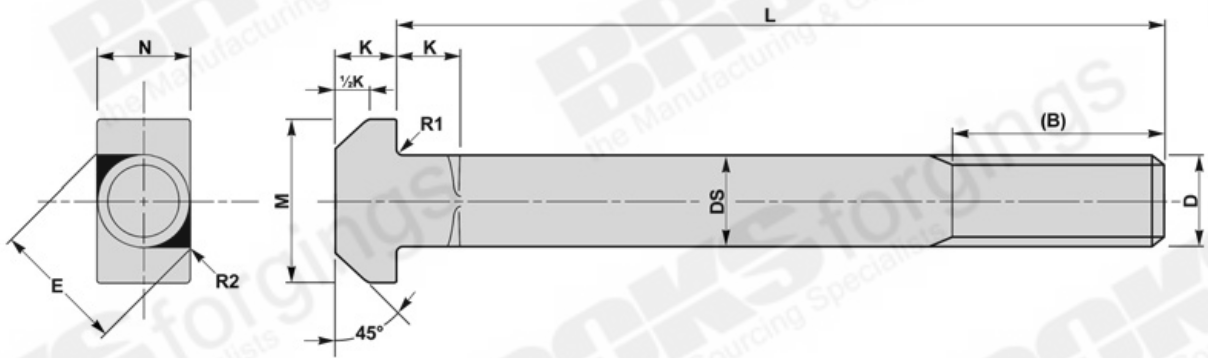

d	PI	B2 ≤ 120	B3 ≤ 200	B4 > 200	ds	K	N	M	R1	R2 max
mm	mm	mm	mm	mm	mm	mm	mm	mm	mm	mm
M24	3	54	60	-	24	15	24	43	1.6	3.6
M30	3.5	66	72	-	30	19	30	54	1.6	4.5
M36	4	78	84	97	36	23	36	66	2	5.4
M42	4.5	-	96	109	42	26	42	80	2	6.3
M48	5	-	108	121	48	30	48	88	2	7.2
M56	5.5	-	124	137	56	35	56	102	3	8.4
M64	6	-	130	143	64	40	64	115	3	9.6
M72	6	-	156	169	72	45	72	128	4	10.8
M80	6	-	172	185	80	50	80	140	4	12

PI - Pitch of thread (coarse)

B2 - For overall length underhead up to and including 120mm

B3 - For overall length underhead up to and including 200mm

B4 - For overall length underhead exceeding 200mm

**SLOTTED PLATES
PAGE 40**

MATERIAL

- CARBON STEELS**
- STAINLESS STEELS**
- ALLOY STEELS**
- B7, 4.6, 5.6, 8.8**

FINISH

- SELF COLOUR**
- GALVANISED**
- ELECTROPLATED**
- SHERARDISED**
- PTFE COATING**



DIN 186 - HAMMERHEAD T BOLTS

BOLTS ARE MANUFACTURED TO REQUIRED LENGTHS IN ACCORDANCE TO DIN 186

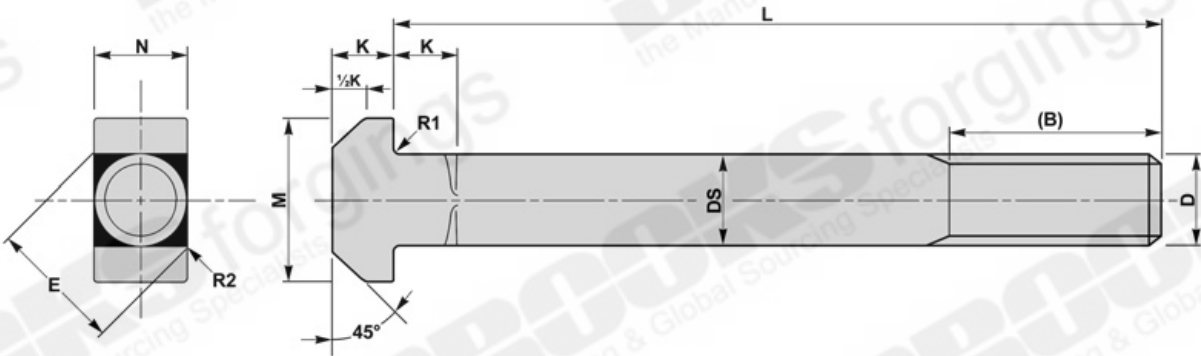

TYPE A - THREADED END

d	PI	ds	B2 ≤ 120	B3 ≤ 200	B4 > 200	E	K	N	M	R1	R2 max
mm	mm	mm	mm	mm	mm	min	mm	mm	mm	mm	mm
M24	3	24	54	60	73	29.48	15	24	43	1.6	3.6
M30	3.5	30	66	72	85	37.20	19	30	54	1.6	4.5
M36	4	36	78	84	97	44.57	23	36	66	2	5.4
M42	4.5	42	-	96	109	52.29	26	42	80	2	6.3
M48	5	48	-	108	128	60.00	30	48	88	2	7.2

TYPE B - FULLY THREADED ALSO AVAILABLE ON REQUEST

SLOTTED PLATES - PAGE 40

PI - Pitch of thread (coarse)

B2 - For overall length underhead up to and including 120mm

B3 - For overall length underhead up to and including 200mm

B4 - For overall length underhead exceeding 200mm

MATERIAL

CARBON STEELS
STAINLESS STEELS
ALLOY STEELS
B7, 4.6, 5.6, 8.8

FINISH

SELF COLOUR
GALVANISED
ELECTROPLATED
SHERARDISED
PTFE COATING

