

DIN 261 - HAMMERHEAD T BOLTS

BOLTS ARE MANUFACTURED TO REQUIRED LENGTHS IN ACCORDANCE TO DIN 261

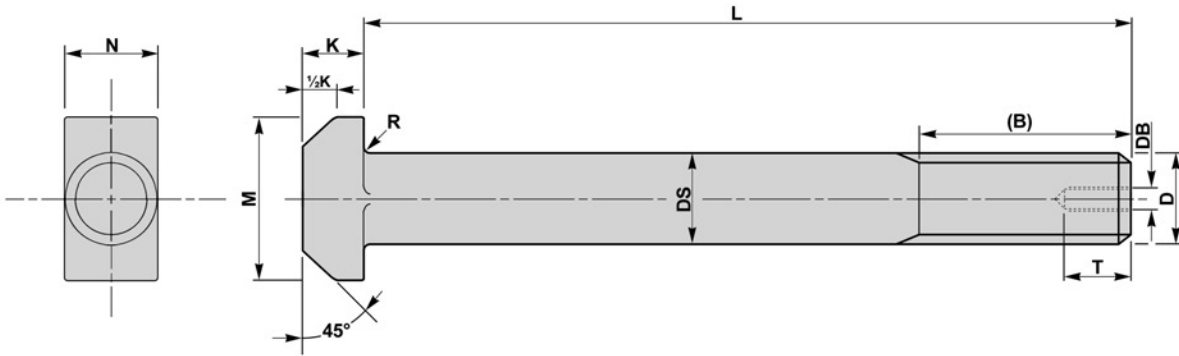

d	PI	B2 ≤ 120	B3 ≤ 200	B4 > 200	db	ds	K	N	M	R min	T
mm	mm	mm	mm	mm	mm	mm	mm	mm	mm	mm	min
M24	3	54	60	73	-	24	15	24	43	0.8	-
M30	3.5	66	72	85	-	30	19	30	54	1.0	-
M36	4	78	84	97	M12	36	23	36	66	1.0	22
M42	4.5	90	96	109	M12	42	26	42	80	1.2	22
M48	5	-	108	121	M12	48	30	48	88	1.6	22
M56	5.5	-	124	137	M16	56	35	56	102	2.0	26
M64	6	-	130	143	M16	64	40	64	115	2.0	26
M72	6	-	-	169	M16	72	45	72	128	2.0	26
M80	6	-	-	185	M20	80	50	80	140	2.0	33
M90	6	-	-	205	M20	90	55	90	155	2.5	33
M100	6	-	-	225	M20	100	62	100	170	2.5	33

DIN 261 WITH REDUCED SHANK ALSO AVAILABLE ON REQUEST

PI - Pitch of thread (coarse)

B2 - For overall length underhead up to and including 120mm

B3 - For overall length underhead up to and including 200mm

B4 - For overall length underhead exceeding 200mm

**SLOTTED PLATES
PAGE 40**

